

Parts List			
ITE	QT	PART #	DESCRIPTION
1	2	A02411	BEARING
2	1	A02441	BASE
3	1	A02444	BRACKET
4	1	A02445	BRACKET
5	2	A02465	VALVEBODY
6	2	A03461	CAP
7	2	A04401	DIAPHRAGM
8	2	A05401	ECCENTRIC
9	4	A06401	FOOT
10	1	A06443	FRONT FAN
11	1	A06444	FRONT FAN
12	2	A07411	GASKET
13	2	A08403	HEAD
14	2	A08461	HOUSING
15	1	A13402	MOTOR
16	2	A14401	COUNTERWEIGHT
17	2	A16461	PLATE
18	2	A18402	TOLERANCE RING
19	2	A18461	CONNECTING ROD
20	8	A19405	HEAD SCREW
21	2	A19411	ECCENTRIC SCREW
22	4	A19418	SCREW
23	2	A19467	PLATE SCREW
24	8	A23402	WASHER
25	2	A23461	WASHER

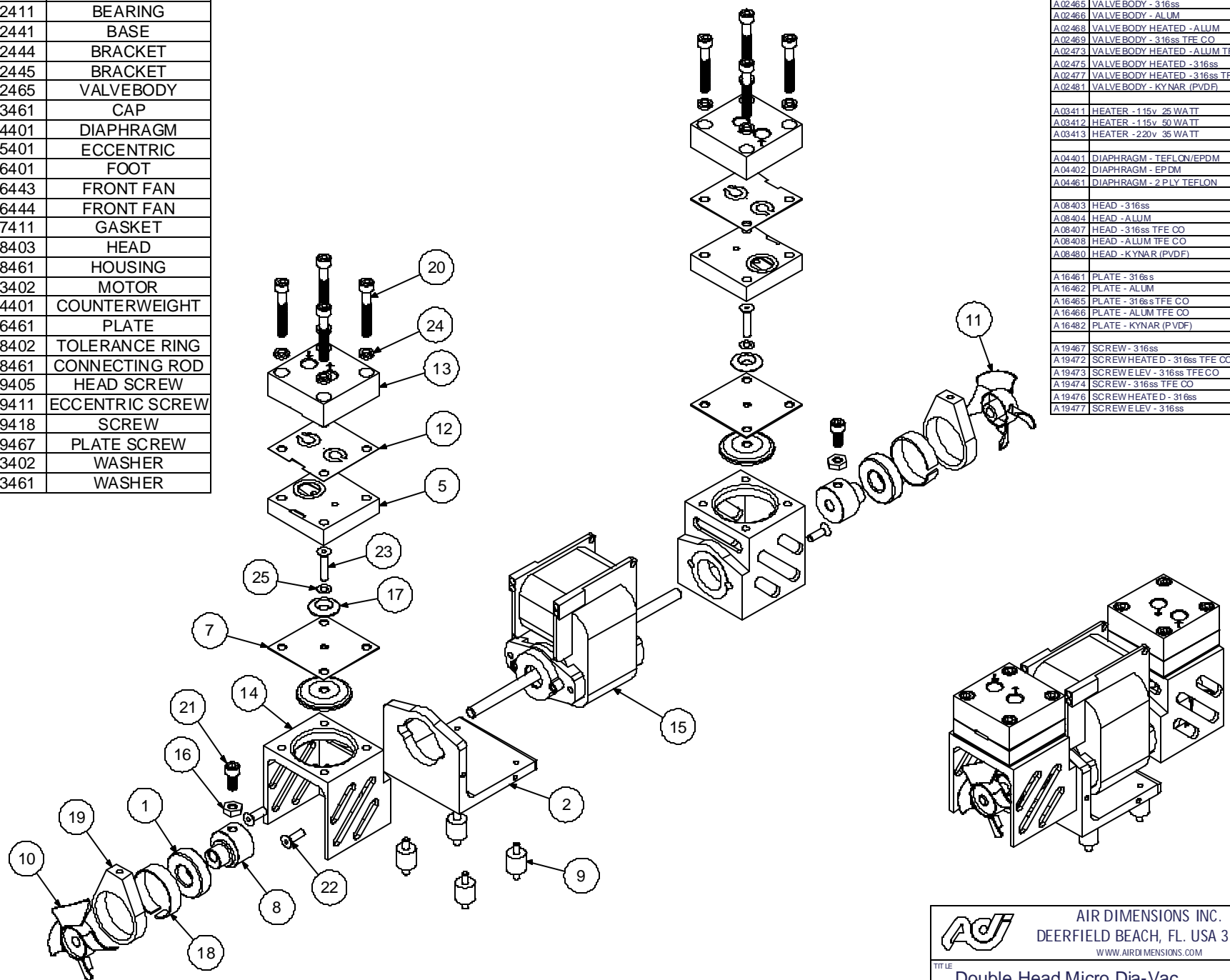

ALTERNATE PARTS	
PART #	DESCRIPTION
A02460	VALVE BODY - ALUM TFE CO
A02465	VALVE BODY - 316ss
A02466	VALVE BODY - ALUM
A02468	VALVE BODY HEATED - ALUM
A02469	VALVE BODY - 316ss TFE CO
A02473	VALVE BODY HEATED - ALUM TFE CO
A02475	VALVE BODY HEATED - 316ss
A02477	VALVE BODY HEATED - 316ss TFE CO
A02481	VALVE BODY - KYNAR (PVDF)
A03411	HEATER - 115v 25 WATT
A03412	HEATER - 115v 50 WATT
A03413	HEATER - 220v 35 WATT
A04401	DIAPHRAGM - TEFLON/EPDM
A04402	DIAPHRAGM - EPDM
A04461	DIAPHRAGM - 2 PLY TEFLON
A08403	HEAD - 316ss
A08404	HEAD - ALUM
A08407	HEAD - 316ss TFE CO
A08408	HEAD - ALUM TFE CO
A08480	HEAD - KYNAR (PVDF)
A16461	PLATE - 316ss
A16462	PLATE - ALUM
A16465	PLATE - 316ss TFE CO
A16466	PLATE - ALUM TFE CO
A16482	PLATE - KYNAR (PVDF)
A19467	SCREW - 316ss
A19472	SCREW HEATED - 316ss TFE CO
A19473	SCREW HEATED - 316ss TFE CO
A19474	SCREW - 316ss TFE CO
A19476	SCREW HEATED - 316ss
A19477	SCREW HEATED - 316ss

ADJ AIR DIMENSIONS INC.
 DEERFIELD BEACH, FL. USA 33442
 WWW.AIRDIMENSIONS.COM

TITLE: **Double Head Micro Dia-Vac**

4/26/2001	MODEL # Bxx2-xx-Axx	DWG NO Bxx2-xx-Axx
-----------	------------------------	-----------------------